

Ring Motion Sensor

Ring Motion Sensor - Basic Setup



Home security beyond the front door

Ring Video Doorbells and Cameras create a Ring of Security around your entire property.

Ring Alarm is the security system that takes your Ring of Security a step further, giving you another level of protection for your property.

Now, you can arm and disarm your system and monitor your home, all from your phone, tablet or PC.

Contents

1. Diagram
2. In-app Setup
3. Connecting the Device
4. Physical Installation
5. Troubleshooting

1. Say hello to your Ring Motion Detector.

Diagram

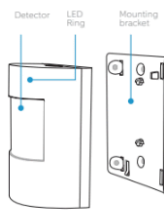

2. Set up your Ring Motion Detector in the Ring app.

Set up your Base Station near your Base Station

In the Ring app, choose **Set Up a Device**.

Choose **Sensors**, then **Ring Motion Detector**.



3. Connect your Ring Motion Detector to your Base Station.

Scan the QR Code or enter the PIN

The QR Code and PIN can be found on the back of your device, on the box, or on the card in this box.

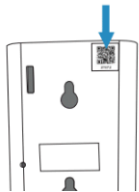

Pull the tab on the detector

This connects the battery and turns on the device. Your Base Station will find it.

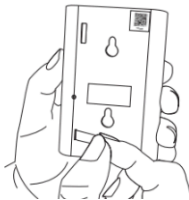

Track the connection progress of the sensor

Your sensor will try to connect to your Base Station. The sensor's LED ring will show you the progress.

- Connected** Blue Solid (5 sec)
- Motion detected** Blue Blink (1x)
- Sensor tampered** Blue Blinks (3x)

4. Install your Ring Motion Detector on the wall.

Place your detector (but don't install it yet)

Hold the detector where you want to install it. Make sure the detector detects motion in the whole area.



Install your detector

Use the bracket and tape or screws included in your kit. The detector can be mounted flush to the wall or angled in a corner.

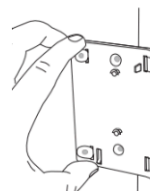

5. Some additional details about your detector.

How to change the battery

Your battery should last quite a long time, but when you need to replace it, press the clip and remove the detector cover.



Ring Motion Sensor – Inclusion

Adding Sensor to a Z-Wave Network

Ring Motion Sensor can be added via smart start or via classic inclusion mode –

Smart Start Inclusion Steps:

1. Initiate add sensor flow in the Ring Alarm mobile application – Follow the guided add flow instructions provided in the application
2. Scan the QR code found on the package of the sensor or the QR code found on the back of the sensor
3. Pull the battery tab on the sensor
4. When the inclusion process is complete, the LED on the sensor will be solid blue, then go out.
5. Test the sensor. Place the sensor in an unoccupied room. Leave the room for at least four minutes. Return to the room and pass in front of the sensor – LED will flash if motion is detected.

Classic Inclusion Steps:

1. Initiate add sensor flow in the Ring Alarm mobile application – Follow the guided add flow instructions provided in the application
2. Select add manually and enter the 5 digit DSK pin found on the package of the sensor or the QR code found on the back of the sensor
3. Pull the battery tab on the sensor
4. When the inclusion process is complete, the LED on the sensor will be solid blue, then go out.
5. Test the sensor. Place the sensor in an unoccupied room. Leave the room for at least four minutes. Return to the room and pass in front of the sensor – LED will flash if motion is detected.

Ring Motion Sensor – Exclusion

Removing a Sensor to a Z-Wave Network

Exclusion Instructions:

1. Initiate remove sensor flow in the Ring Alarm mobile application – Select the settings icon from device details page and choose “Remove Device”
2. Open motion sensor’s cover
3. Remove and replace battery quickly

Ring Motion Sensor – Lifeline

Association

This sensor has two Association groups of 1 nodes each. Group 1 is a lifeline group who will receive unsolicited messages relating to Motion Detected/Not Detected notifications, case tampering notifications, and low-battery notifications. When a node is associated with Group 2, the sensor will send a basic report of either 0xFF for “motion” or 0x00 for “no motion.”

Ring Motion Sensor – Reset

Factory Default Instructions

1. Using a pointed end of a paperclip, press and hold the reset button via the reset pin hole found at the back of the sensor
2. Blue LED will start to blink rapidly
3. Wait for the blue LED to stop blinking

Use this procedure only in the event that the network primary controller is missing or otherwise inoperable.