

## Step 1

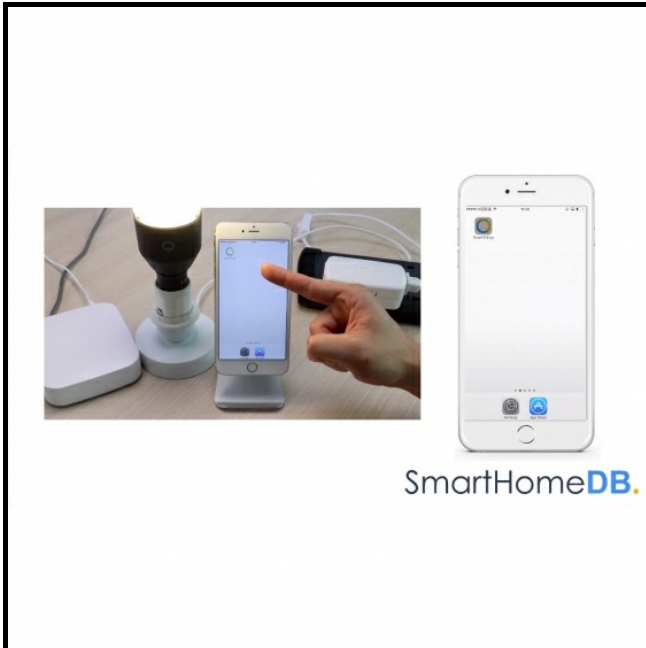

- Open the SmartThings App on your mobile device.

## Step 2

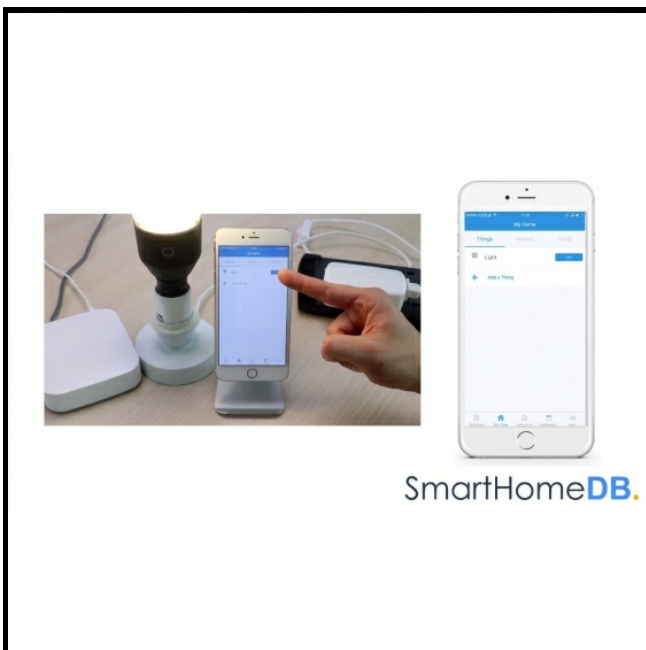

- Tap on 'GE Smart Switch' or another name which is associated with your GE Smart Switch.

### Step 3

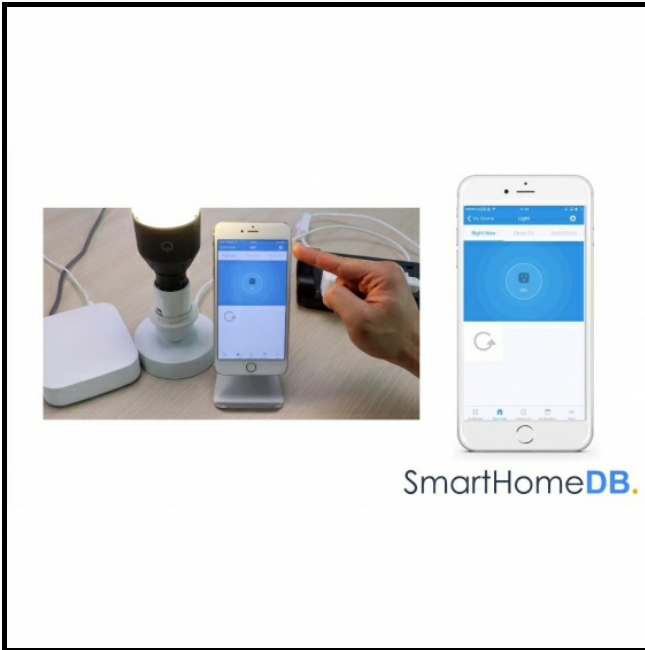

- Tap on the 'Settings Icon' at the right top.

### Step 4

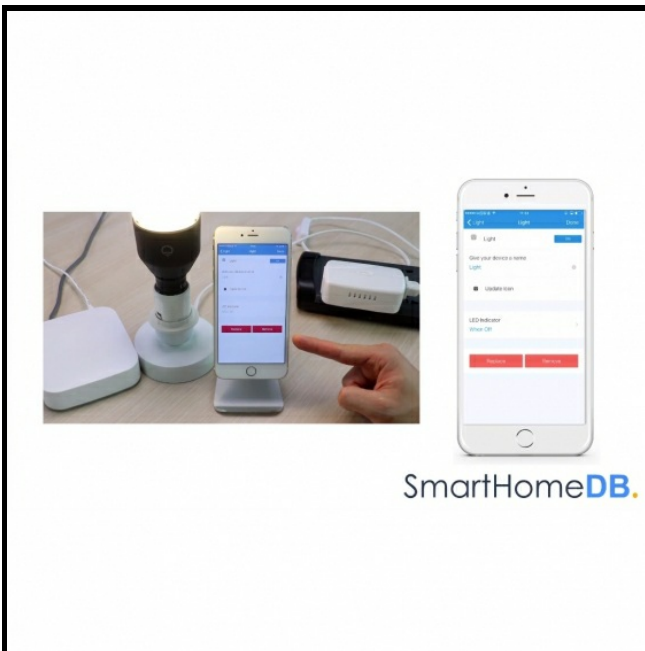

- Tap on 'Remove' on the 2 following screens.

## Step 5

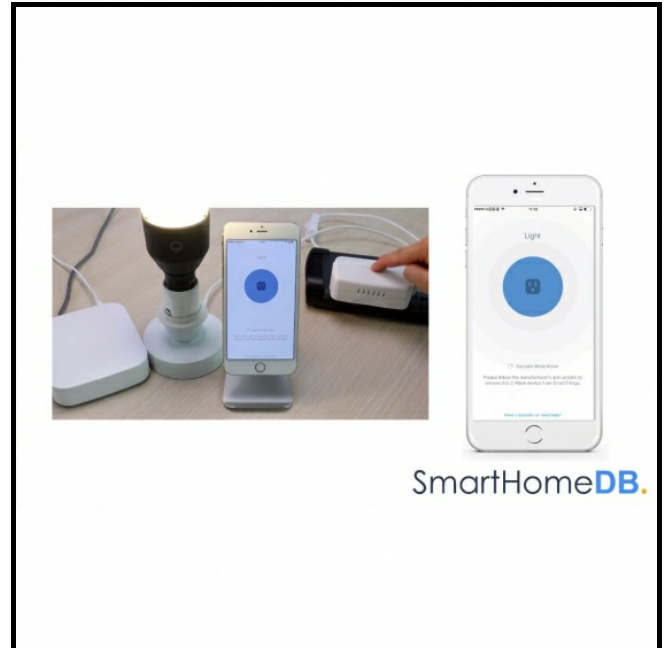
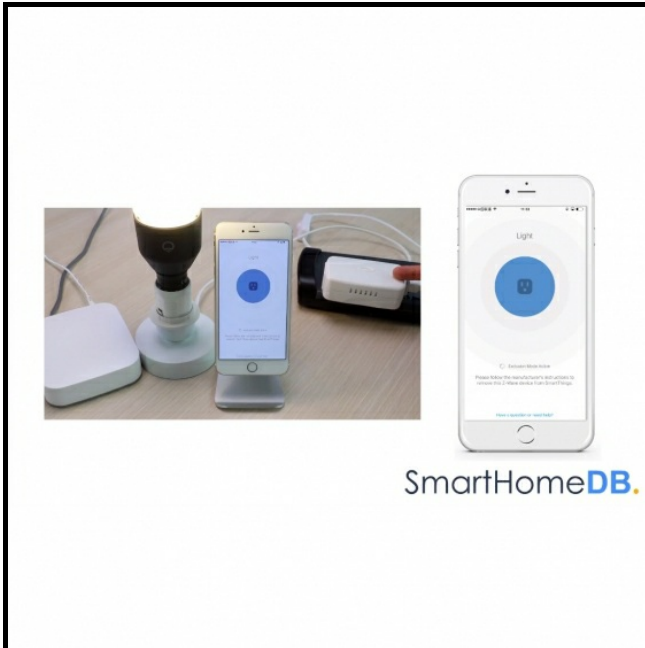

- Proceed by pressing on the action button found at the front side of the GE Smart Switch.

## Step 6

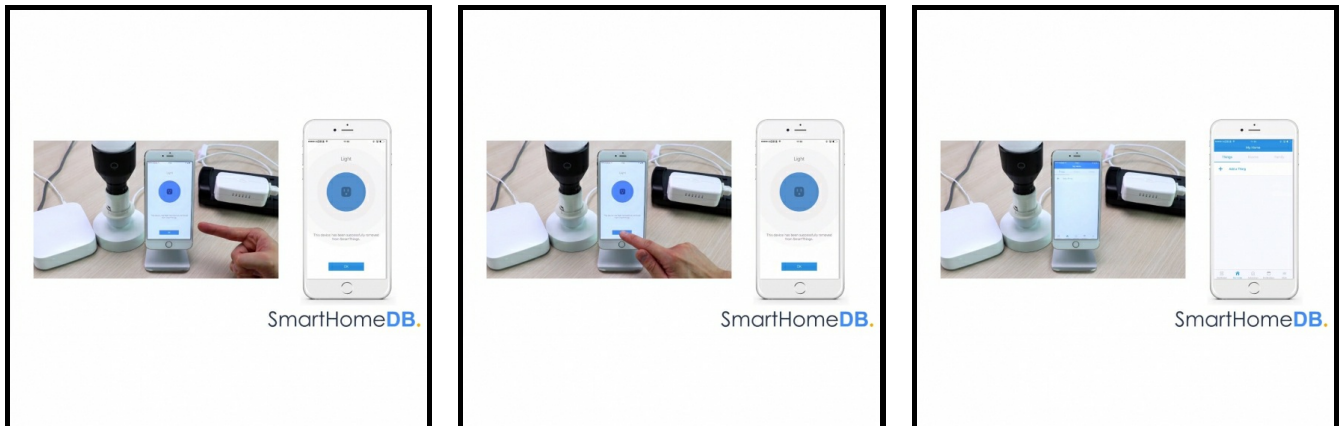

- The SmartThings App will show a confirmation message indicating that the GE Smart Switch has been successfully removed from the Samsung SmartThings Hub.
- Tap on 'OK'.
- You have hereby successfully unpaired the GE Smart Switch from the Samsung SmartThings Hub.