

## Step 1

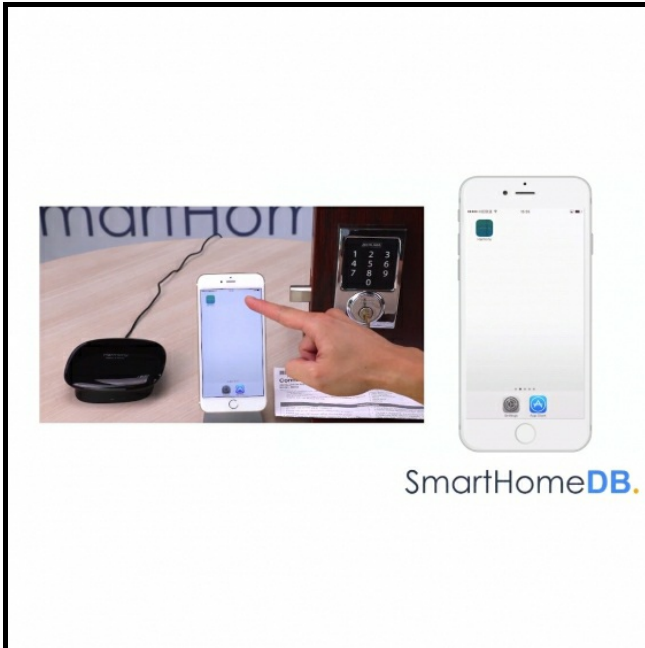

- Open the Harmony App on your mobile device.

## Step 2

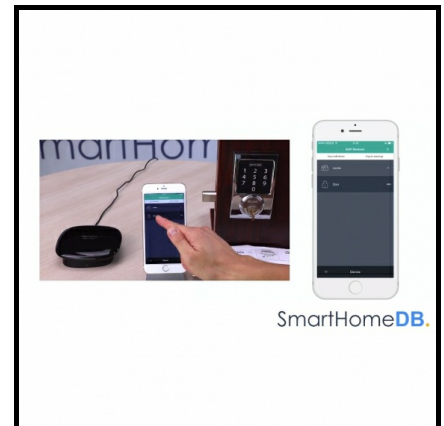
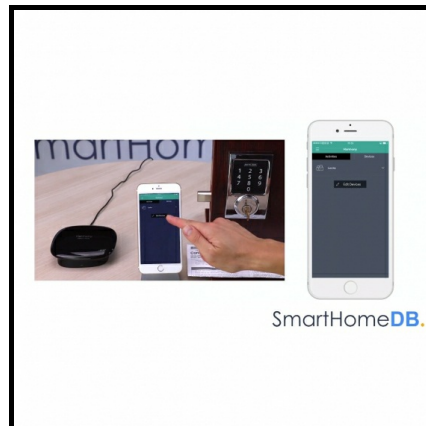
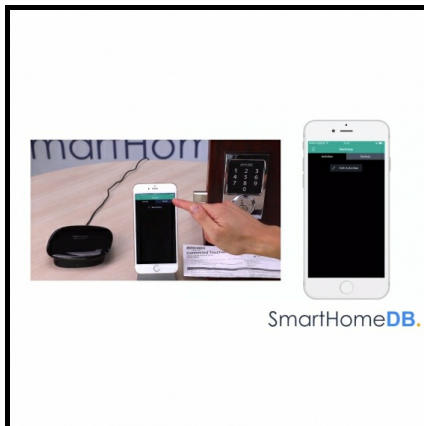

- Tap on 'Devices'.
- Tap on 'Edit Devices'.
- And tap on the device which is associated with your Schlage Lock.

### Step 3

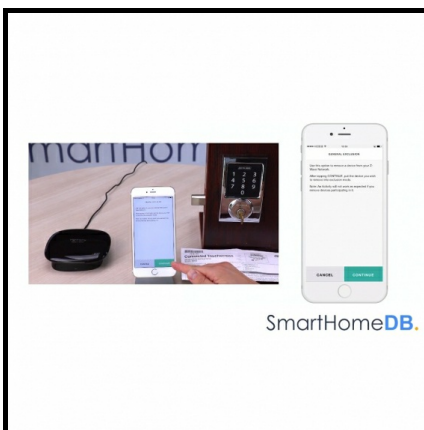
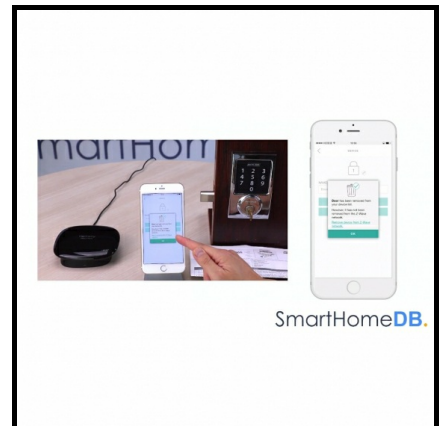
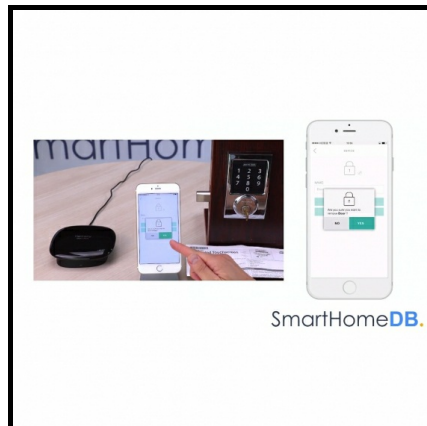
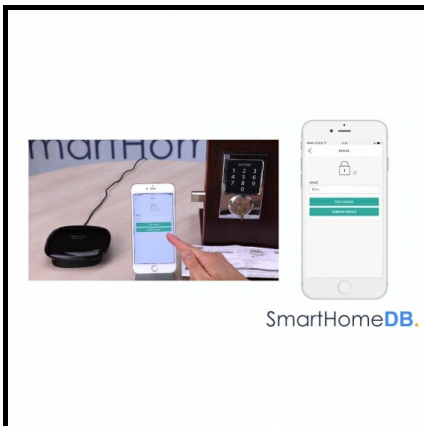

- Tap on 'Remove Device'.
- Tap on 'Yes'.
- Tap on 'Remove device from Z-Wave network'.
- And tap on 'Continue'.

## Step 4

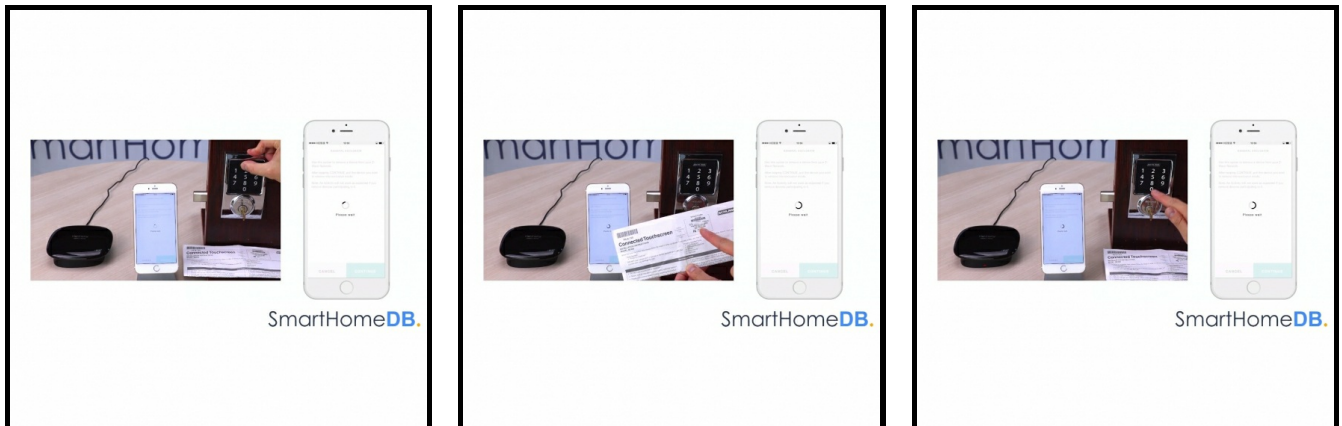

- Proceed by pressing on the 'Schlage' button at the front of the Schlage Lock followed by your unique programming code which you can find on the sticker on your instruction manual.
- Finish by tapping on '0' on the Schlage Lock.
- You will be shown a success message, a green check mark, on the Schlage Lock. Indicating that the unpairing process was successful.

## Step 5

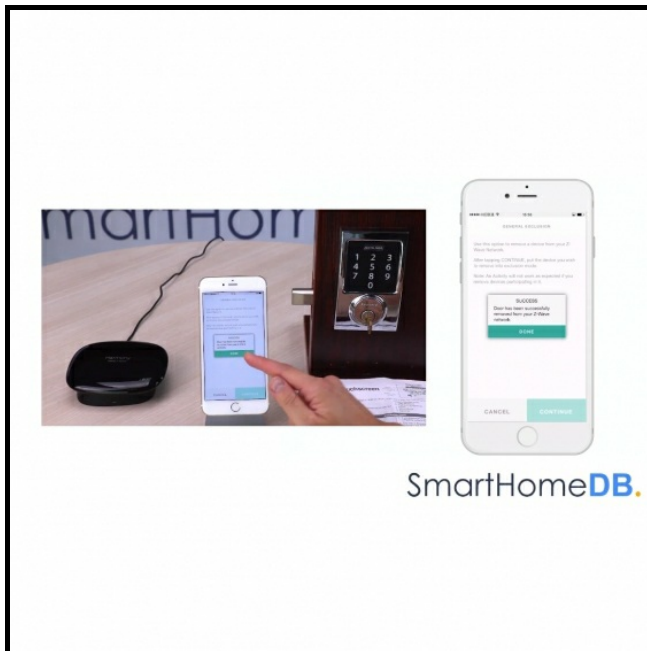

- The Harmony App will indicate that it has successfully removed the Schlage Lock from your Z-Wave network.
- Tap on 'Done'.
- You have hereby successfully unpaired the Schlage Lock from the Logitech Harmony Home Hub with Extender.