

Step 1

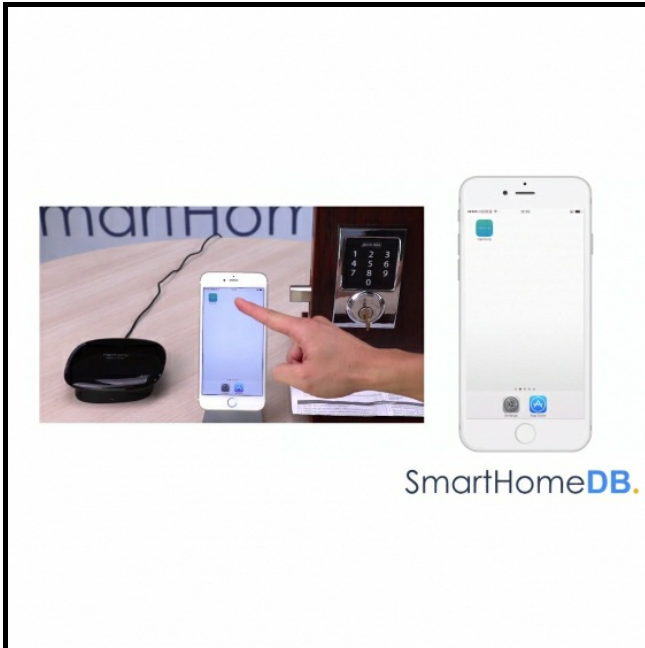

- Open the Harmony App on your mobile device.

Step 2

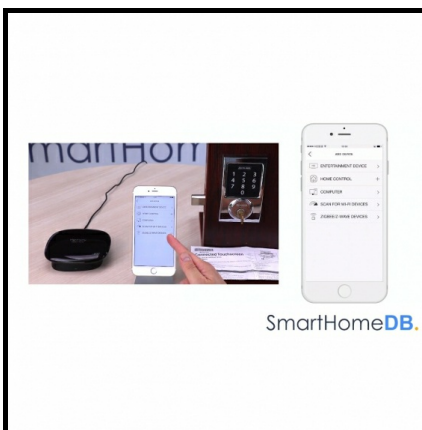
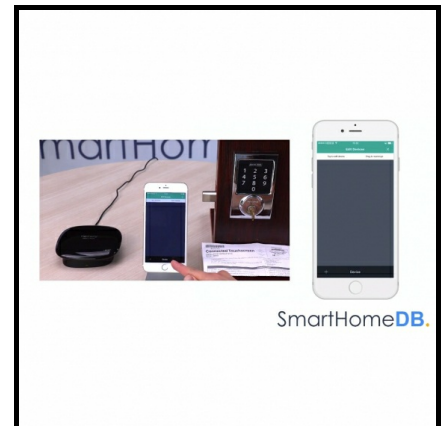
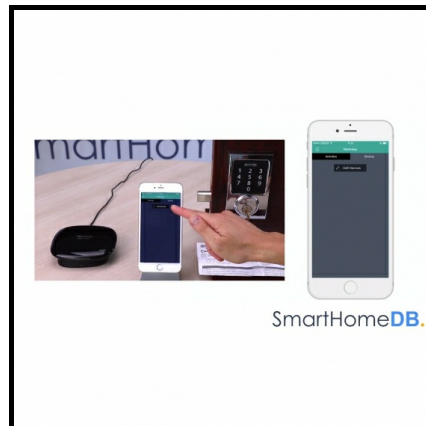
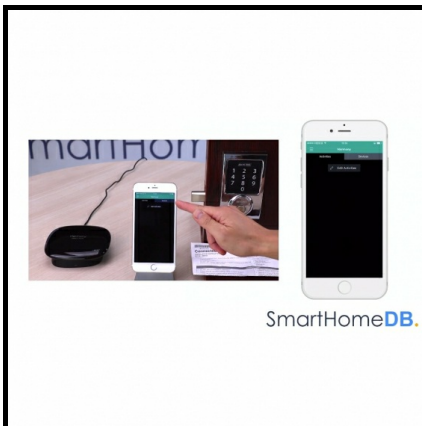

- Tap on 'Devices'.
- Tap on 'Edit Devices'.
- Tap on add '+ Device'.
- And tap on 'Zigbee/Z-Wave Devices'.

Step 3

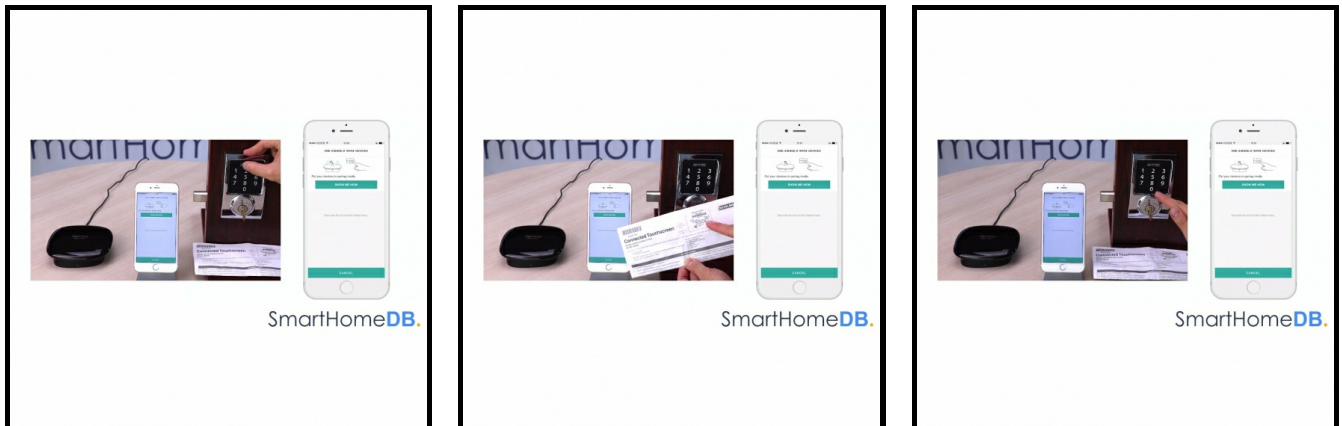

- Proceed by pressing on the 'Schlage' button at the front of the Schlage Lock followed by your unique programming code which you can find on the sticker on your instruction manual.
- Finish by tapping on '0' on the Schlage Lock.
- You will be shown a success message, a green check mark, on the Schlage Lock. Indicating that the pairing process was successful.

Step 4

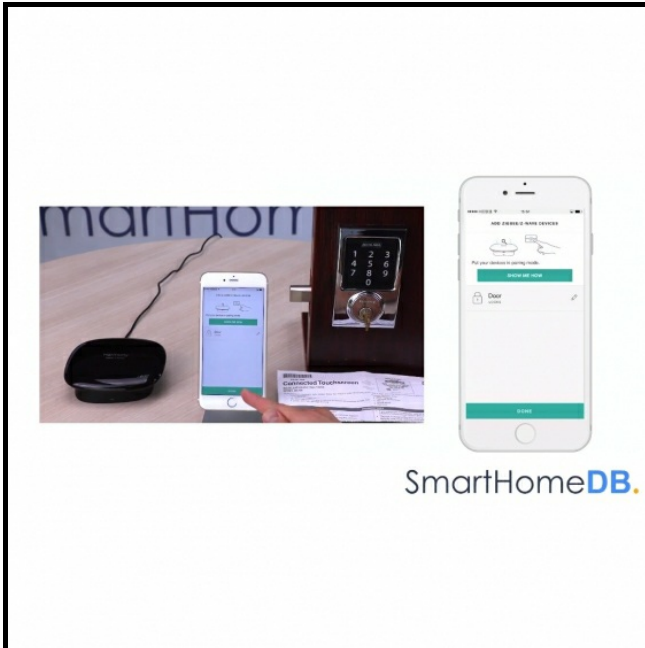

- The Harmony App will indicate that it has found the Schlage Lock.
- Tap on 'Done'.

Step 5

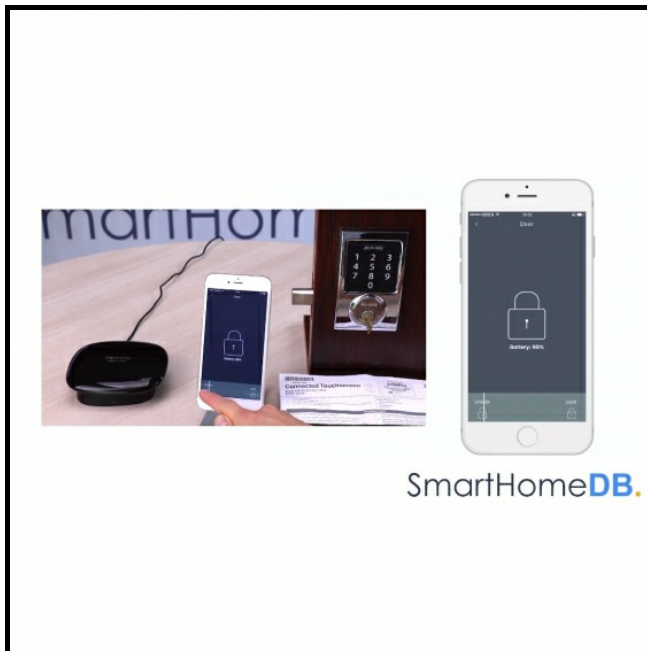

- You have hereby successfully paired the Schlage Lock with the Logitech Harmony Home Hub with Extender.