

Step 1

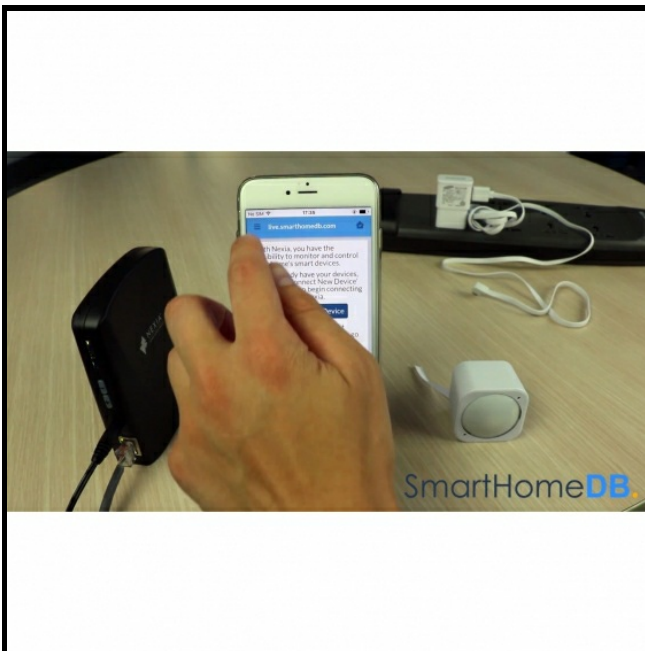

- Open the Nexia App on your mobile device.

Step 2



- Tap on the 'Left Top Menu Button'.

Step 3

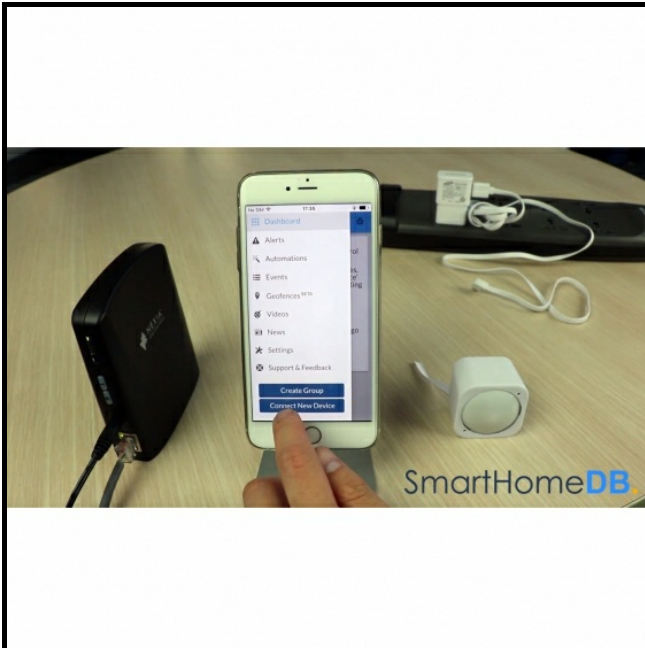

- In the menu tap on 'Connect New Device'.

Step 4

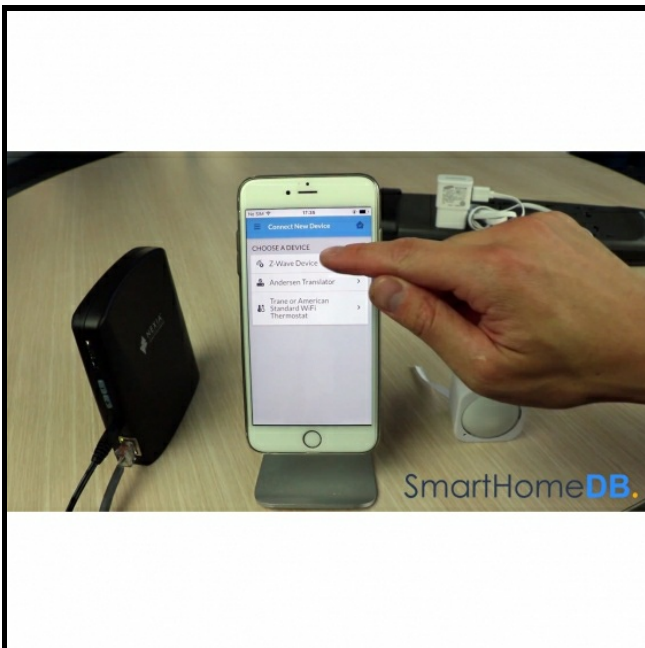

- Tap on 'Z-Wave Device'.

Step 5



- Tap on 'Continue'.
- The Nexia Bridge's Z-Wave Light will now blink orange indicating that it is in pairing mode.

Step 6

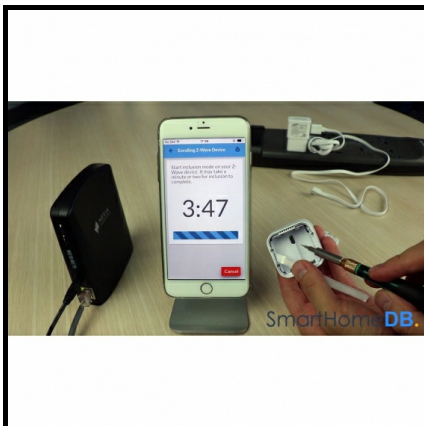

- Power up the Aeotec MultiSensor 6 via either the Micro-USB slot or by inserting 2 CR123A batteries.

Step 7



- Press on the 'Action Button' found at the backside of the Aeotec MultiSensor 6.

Step 8

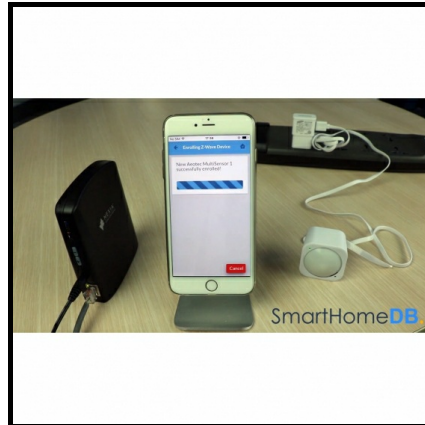

- The Nexia App will indicate that it has found the Aeotec MultiSensor 6 and that the pairing process has been successful.
- You have hereby successfully paired the Aeotec MultiSensor 6 with the Nexia Bridge.