

## Step 1

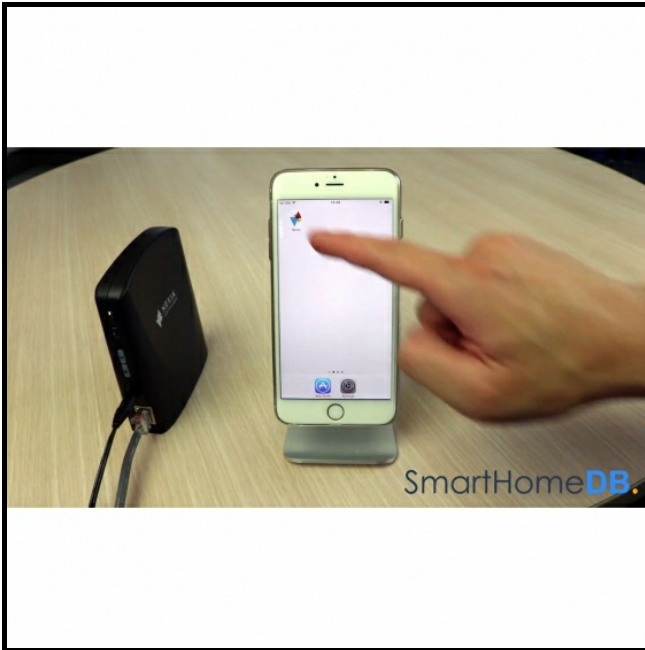

- Open the Nexia App on your mobile device.

## Step 2

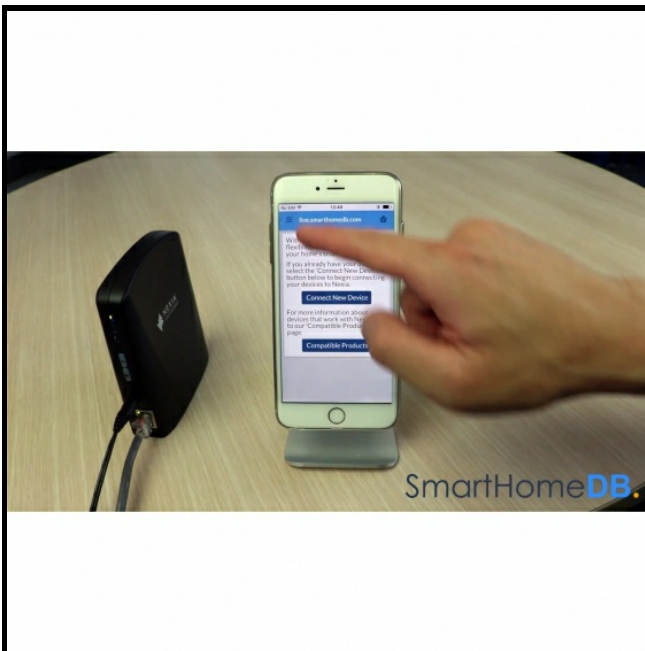

- Tap on the 'Left Top Menu Button'.

### Step 3

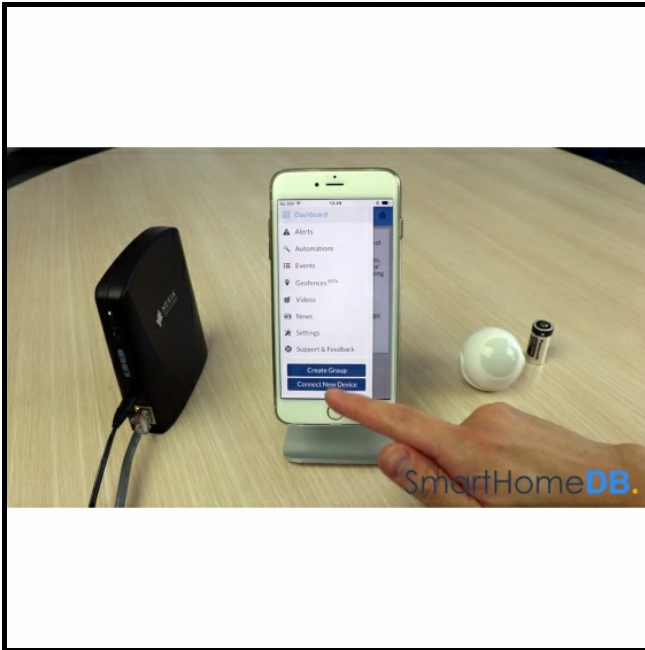

- In the menu tap on 'Connect New Device'.

### Step 4

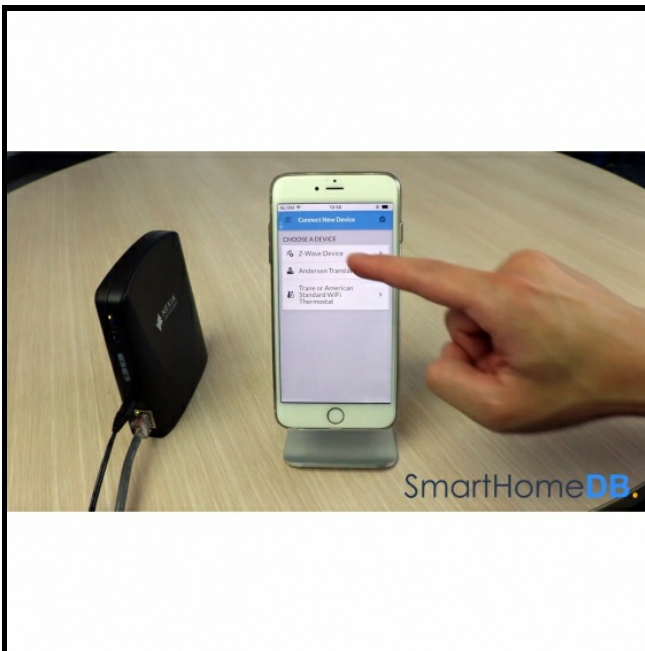

- Tap on 'Z-Wave Device'.

## Step 5

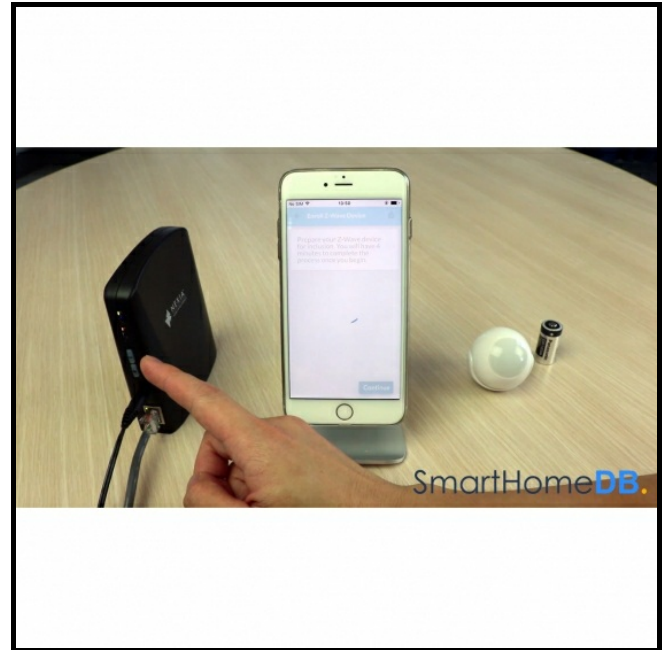
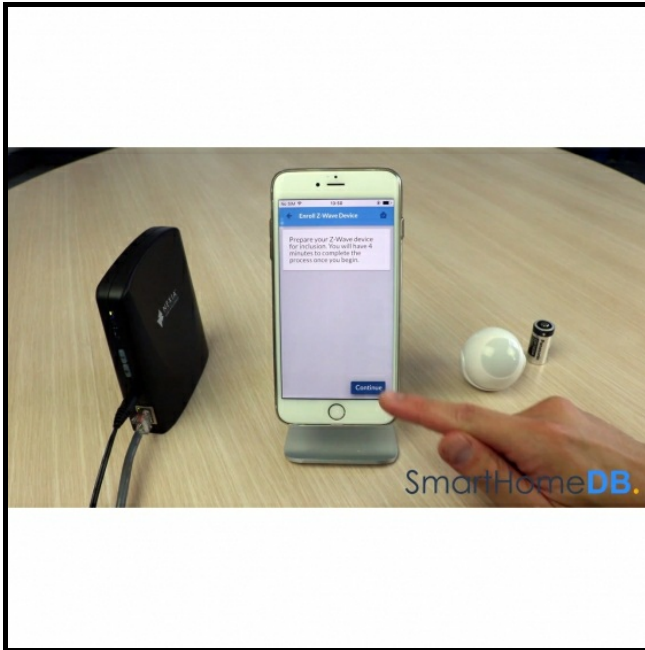

- Tap on 'Continue'.
- The Nexia Bridge's Z-Wave Light will now blink orange indicating that it is in pairing mode.

## Step 6



- Insert the CR123A battery into the Fibaro Motion Sensor.

## Step 7

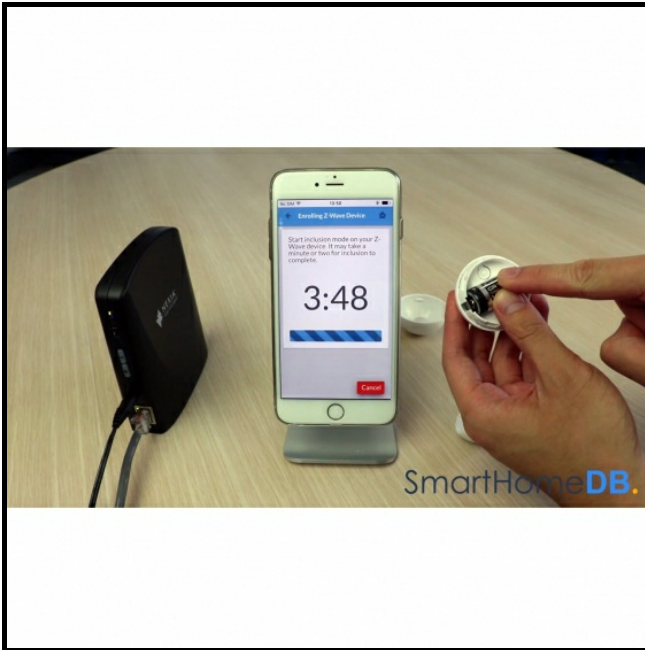

- Tap 3 times on the 'Action Button' of the Fibaro Motion Sensor resulting in the LED glowing blue.

## Step 8

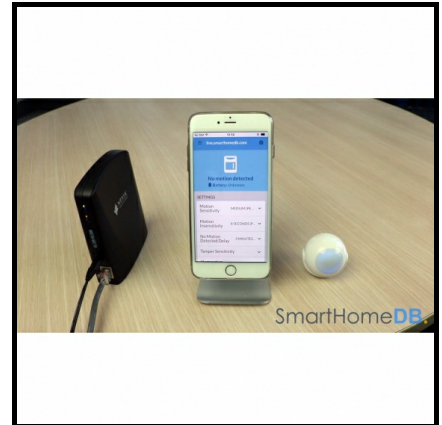
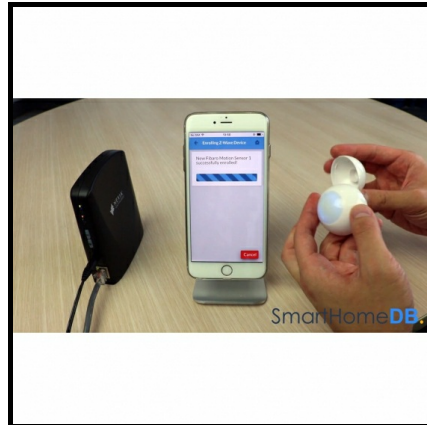

- The Nexia App will indicate that it has found the Fibaro Motion Sensor and that the pairing process has been successful.
- You have hereby successfully paired the Fibaro Motion Sensor with the Nexia Bridge.