



EBV105 Quick Start Guide

Specifications

- The EBV105 Z-Wave Valve Controller requires 12V DC input at 1Amp (AC to DC Adapter included). The EBV105 can be paired with, and controlled using any Z-Wave compatible controller. The EBV105 also acts as signal repeater for the Z-Wave network, extending the Z-Wave transmission as part of the “mesh network”. The EBV105 is designed to work with a pre-installed standard levered ball type water shut off valve. If your water shut off valve is not a levered type, consult a plumber to have your shut off valve changed to a levered type.
- The EBV105 is designed to be installed onto an existing levered type ball valve as detailed below. **Caution:** If you do not have experience installing and configuring EBV105 type of devices, please consult a professional installer.

- Model: EBV105 (U.S.)
- Rated Voltage: 12V DC/1A
- Z-Wave Plus, 908MHz
- Wireless Range: 30M (line of sight)
- Valve Pressure: 1.6Mpa
- Valve Size: ½” , ¾” , 1” (optional 1.25”)
- Close Time: 5 ~ 10 seconds
- Open Time: 5 ~ 10 seconds
- Torque: 30~60 kg.cm
- Accessories: 12V/1A power adaptor



Pairing the EBV105 Z-Wave Automatic Valve with a Z-Wave Controller

Including or Pairing the EBV105 to a Z-Wave Controller: Place the Z-Wave controller in pairing (learning) mode. Press the SET/Power button 3 or more times rapidly (within 0.5 seconds). Once the controller has acknowledged the inclusion, the EBV105 has been included in the Z-Wave network with the controller. Exit the pairing mode and you should see the EBV105 Automatic Valve under your list of devices. Some devices (like the Vera controller) require that you reload or refresh the controller so it polls, identifies, and configures the new device. Once the configuration is complete, you can control the powered valve through your Z-Wave controller’s user interface. The valve supports Open or On command and Closed or Off command through a standard Z-Wave controller. The valve can also be open or closed with a single push of the power button on the unit, toggling from open to closed or closed to open. The valve can also be open/closed manually by hand by pulling the clutch pin.

Excluding or Un-Pairing the EBV105 to a Z-Wave Controller: Place your Z-Wave controller in exclusion (un-learning) mode. Once the controller is in exclusion mode, bring the EBV105 close to the Z-Wave controller (several feet) and press the Power button 3 or more time rapidly (within 0.5 seconds). Once the controller has acknowledged the exclusion, the EBV105 has been cleared of any previous inclusions/pairings. (It is recommended to keep the EBV105 within 1M/3ft of the controller when pairing or un-pairing)

There can be a number of reasons that the EBV105 does not work with your controller. If the inclusion process does not work the first time, repeat the process but try “excluding” first and then complete the “inclusion” process.

EBV105 Z-Wave Plus Commands:			
Z-Wave Network inclusion	Power button 3 or more time rapidly (within 1.5 seconds). It is recommended to keep the EBV105 within 1M/3ft of the controller. (Set controller to inclusion mode first)		
Z-Wave Network exclusion	Power button 3 or more time rapidly (within 1.5 seconds). It is recommended to keep the EBV105 within 1M/3ft of the controller. (Set controller to inclusion mode first)		
Device Reset	Press and hold the Power button for 10 seconds. The device will send the reset notification to the list node in the group-1 and erases the device memory. The led light flashes acknowledging successful reset. Note: This should only be used in the event your networks primary controller is missing or otherwise inoperable		
Association capabilities	Setting the association: this device supports the "Switch_Binary_report" to the node. Group 1-Lifeline setting supports up to 5 Nodes. (Group 2~5 is not supported)		
Z-Wave Command Class	COMMAND_CLASS_BASIC COMMAND_CLASS_VERSION COMMAND_CLASS_ZWAVEPLUS_INFO COMMAND_CLASS_MANUFACTURE_SPECIFIC COMMAND_CLASS_DEVICE_RESET_LOCALLY COMMAND_CLASS_POWERLEVEL COMMAND_CLASS_ASSOCIATION COMMAND_CLASS_ASSOCIATION_GROUPINFO COMMAND_CLASS_SWITCH_BINARY COMMAND_CLASS_SWITCH_ALL		

If you have any questions or if you are experiencing any issues with the EBV105, please contact EcoNet Controls Support via email at support@EcoNetControls.com or by phone at 905-332-8856. For more details, please visit www.EcoNetControls.com.

EBV105 mechanical installation: Universal Mounting kit (UMK) includes:

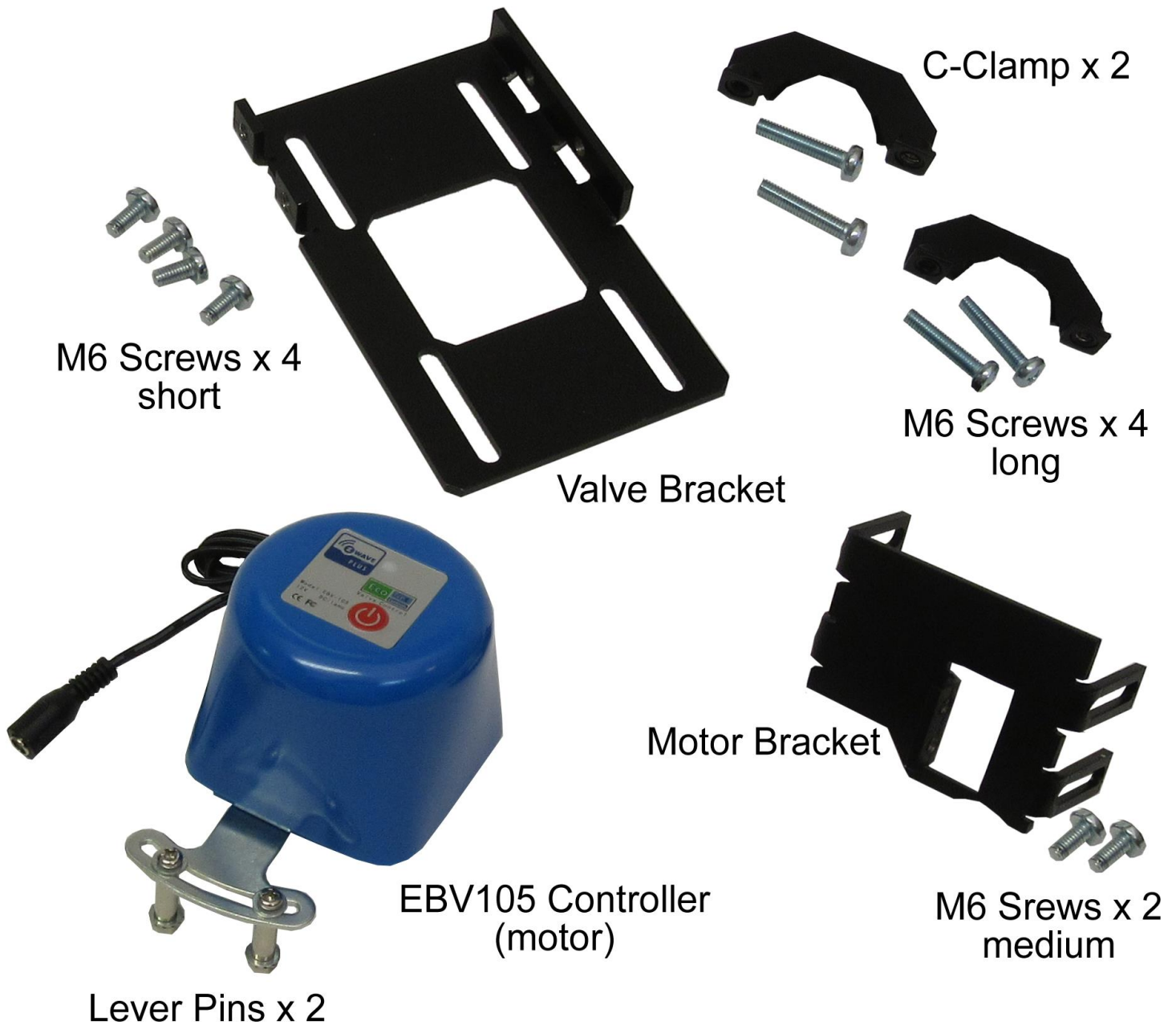

Caution:

After mechanical installation, check lever movement manually, by hand, before connecting to 12V power. To be sure the valve mounting is correct, pull and hold the clutch pin open and make sure the lever movement, by hand, is smooth. If not, check mechanical installation to ensure correct positioning.

Please contact us if the included mounted kit does not support your valve type/size as we have other mounting kits available. (see installation video at www.EcoNetControrols.com)

EBV105 mounting instructions:

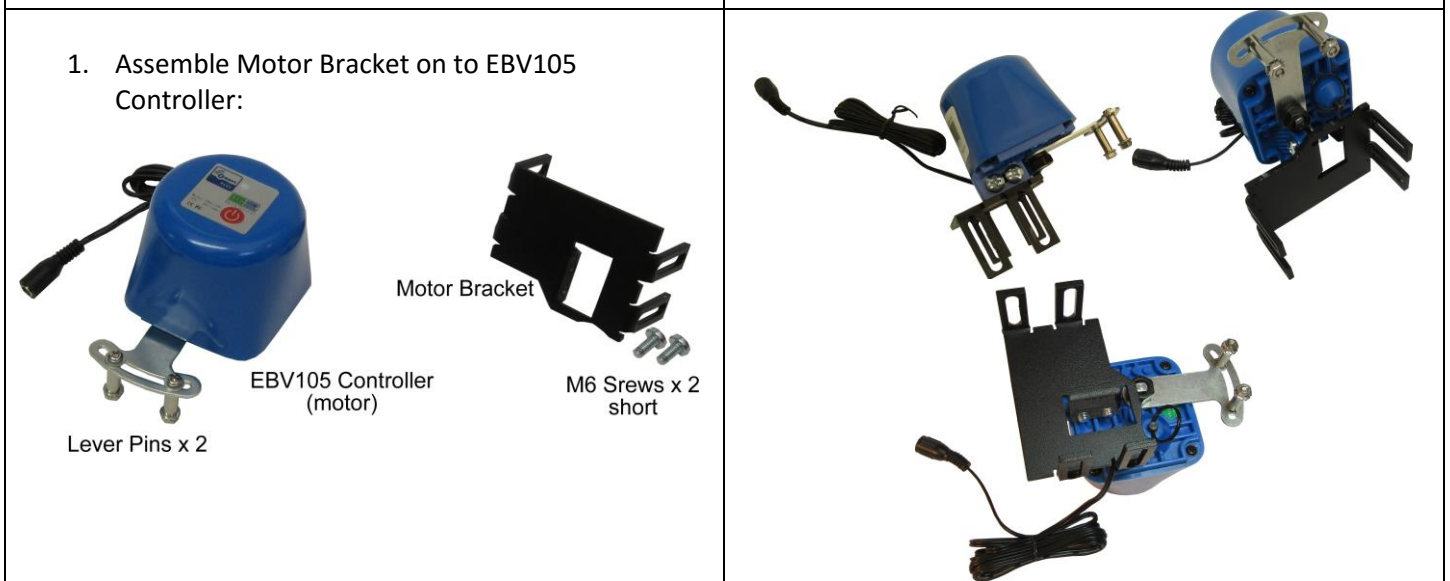
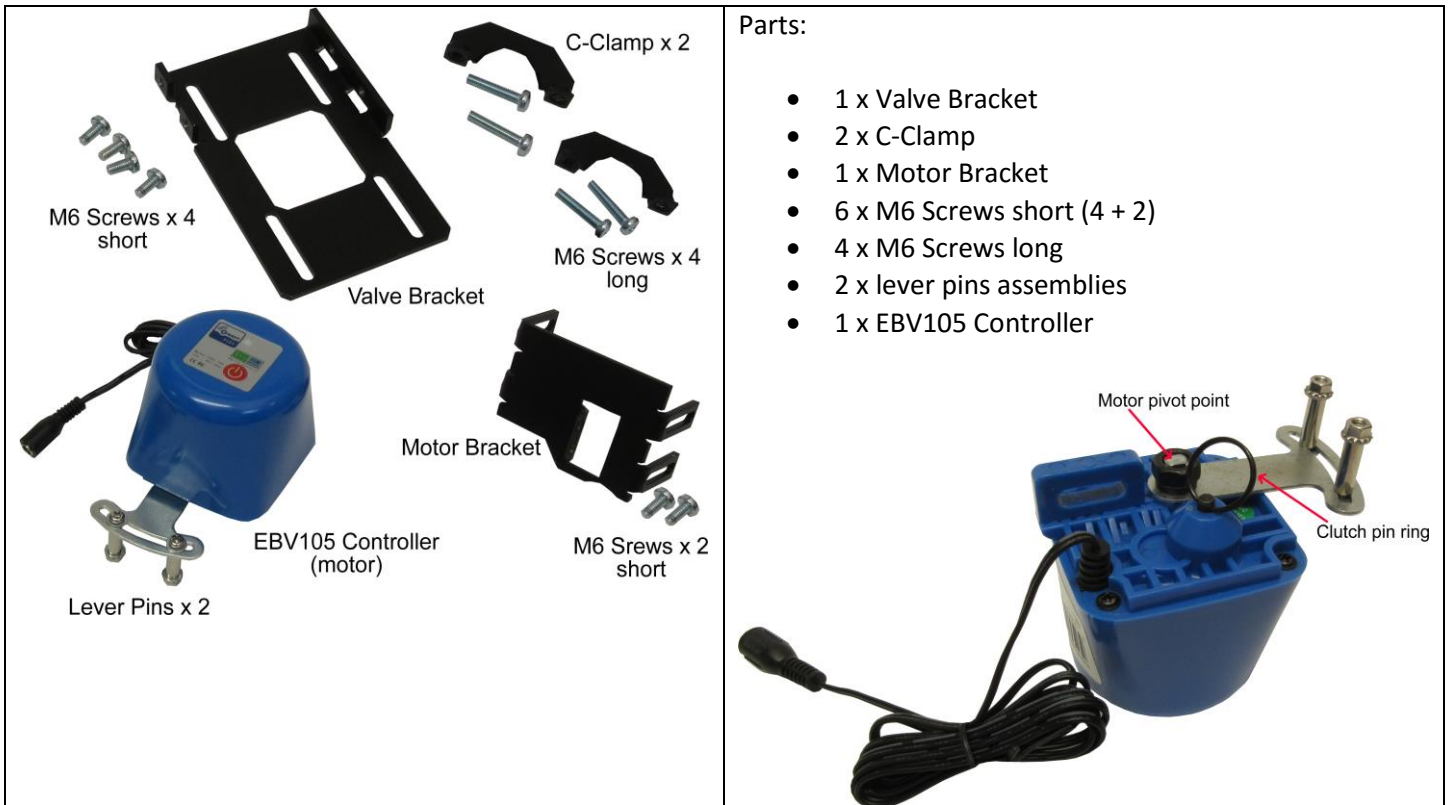

2. Assemble Valve Bracket on to valve

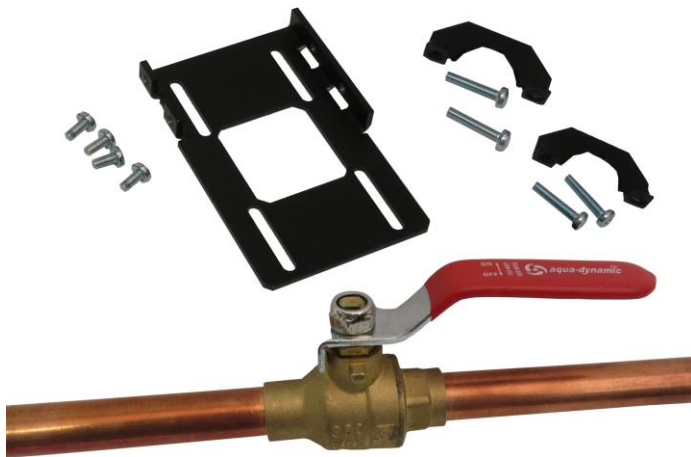

Caution: Fix assembly to valve only. No clamps, screws or brackets should connect direct to pipe.



- Position valve level, straight and centered in valve bracket. Finger tighten screws to allow horizontal adjustment to center pivot point of motor drive with pivot point of valve.

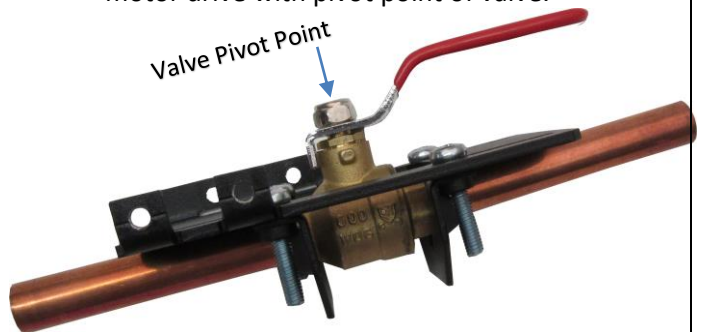

3. Assemble Motor/Bracket onto Valve/Bracket

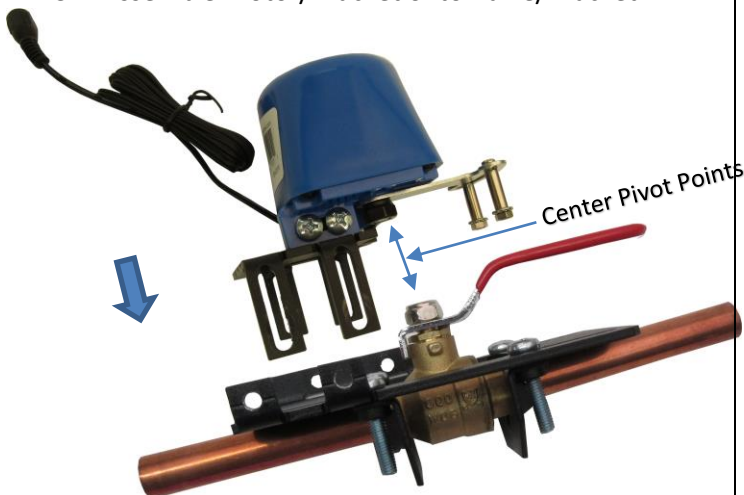

Position motor assembly into slots of valve assembly. Check and adjust horizontal position of valve assembly to center pivot points. Tighten valve assembly screws.



- Test that the valve stroke is smooth by pulling the clutch-pin and manual operating the valve. Adjust position of lever pins to optimize the completion of the open and close stroke.
- Set and level vertical position (up/down) of motor assembly so that the pivot points are close but not touching and so that the lever pins are engaged over valve lever. Tighten the 4 x motor assembly screws securing it to the valve assembly.